

REVISION HISTORY				
REV	DESCRIPTION	AUTH	DATE	APPROVED
A	INITIAL RELEASE		3/16/07	R. WELLS

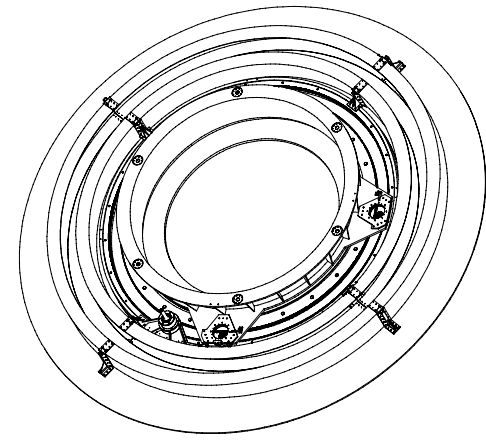
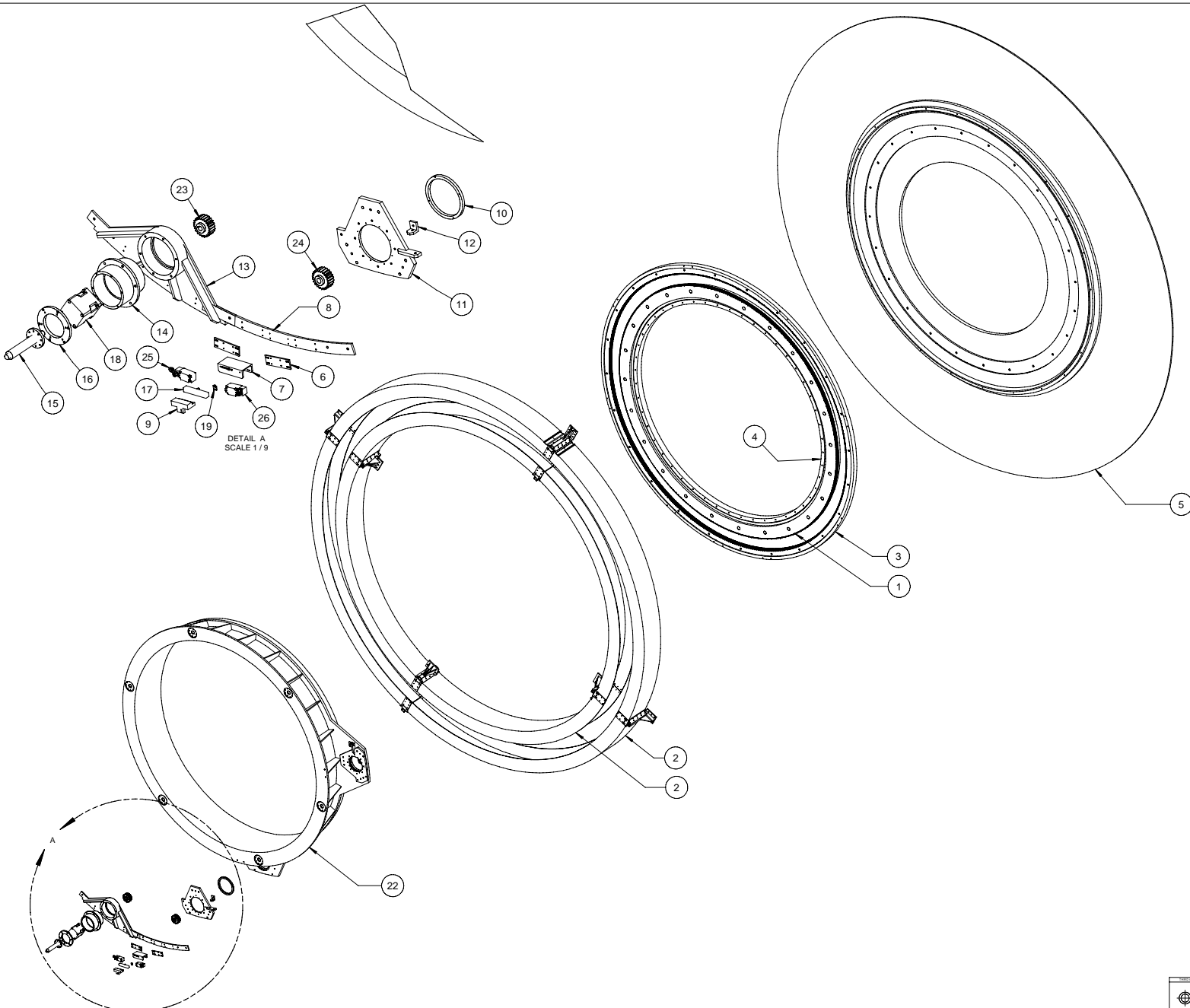

QTY	PART NUMBER	DESCRIPTION	VENDOR	ITEM
2	switch_xckj10511h29_ext_02		Telemecanique	26
2	switch_xckj10511h29_ext_01		Telemecanique	25
2	gregorian pinion with shaft			24
1	gregorian pinion			23
1	gregorian instrument support new			22
2	d103-22-x3xx	Kollmorgen Motor (Not Shown)	Kollmorgen	21
1	0903-12-x2xx	Kollmorgen Motor (Not Shown)	Kollmorgen	20
1	Targis T-F90-G		Tuick	19
1	PS115 Parker Bayside		bayside Automation	18
1	PM1120-F90-IE&V15		Tuick	17
1	6746114	Kollmorgen Motor Adapter Plate		16
1	6746112	Cable Chain Motor Pulley Shaft		15
1	6746110	Cable Chain Gear Box Can		14
1	6746109	Gregorian Cable Chain Motor Mount Plate		13
2	6746108	Rotor Drive Motor Pitch Set Bracket		12
2	6746107	Rotor Drive Motor Mounts		11
2	6746106	Rotor Drive Locating Ring		10
1	6746105	Gregorian Rotator Flag Post		9
1	6746104	Gregorian Rotator Bearing Cutout Cam Plate		8
1	6746103	Gregorian Proximity Sensor Mount Plate		7
2	6746102	Gregorian Cut Out Switch Plate		6
1	6746100	Gregorian Mirror Cell Bottom	Not used	5
1	674600x	Gregorian Rotator Bearing		4
1	6746009	Gregorian Cablewrap Bearing		3
1	6746007	Cable Wrap Assembly		2
1	6746004	Gregorian Bearing Stator		1

PARTS LIST		LARGE BINOCULAR TELESCOPE	
6	Telescope Auxiliaries		
67	Instrument Rotators		
674	Nasmyth Rotator		
674s	Direct Gregorian Rotator		
	Direct Gregorian Rotator Assembly		